



Public Building Commission of Chicago

Contractor Networking Session
November 21, 2013





Public Building Commission of Chicago

Contractor Networking Session

November 21, 2013

WELCOME

DOUGLAS L. MACLIN,
PRINCIPAL,
CHICAGO VOCATIONAL CAREER ACADEMY



Public Building Commission of Chicago

Contractor Networking Session

November 21, 2013

WELCOME

DONNE E. TROTTER,
SENATOR, 17TH DISTRICT, ILLINOIS



Public Building Commission of Chicago

Contractor Networking Session

November 21, 2013

PROJECT INTRODUCTION

ERIN LAVIN CABONARGI,
EXECUTIVE DIRECTOR, PBC



Public Building Commission of Chicago

Contractor Networking Session

November 21, 2013

Prequalified GC's for Phase I Renovation

- Berglund Construction Company
- Blinderman Construction Company
- Burling Builders, Inc.
- Friedler Construction Co.
- James McHugh Construction Co.
- Old Veteran Construction, Inc.
- Power & Sons Construction/IHS Construction JV
- The George Sollitt Construction Company
- Tyler Lane/Illinois Window & Glass JV
- Wight Construction Services



Public Building Commission of Chicago

Contractor Networking Session

November 21, 2013

Prequalified GC's for Phase II Demolition

- American Demolition Corporation
- Berglund Construction Company
- Brandenburg Industrial Service Company
- Friedler Construction Co.
- McDonagh Demolition Inc.
- Old Veteran Construction, Inc.
- Power & Sons Construction/IHS Construction JV



Public Building Commission of Chicago

Contractor Networking Session

November 21, 2013

PBC PRESENTATION ON BUILDING DESIGN

KERL LAJEUNE,
SENIOR DESIGN MANAGER, PBC



Public Building Commission of Chicago

Contractor Networking Session

November 21, 2013



2100 E. 87th Street



Public Building Commission of Chicago

Contractor Networking Session

November 21, 2013



Photo by Lee Bey



Photo by Lee Bey



Public Building Commission of Chicago

Contractor Networking Session

November 21, 2013





Public Building Commission of Chicago

Contractor Networking Session

November 21, 2013

New & Renovated Features:

- Interior program renovations and upgrades:
 - Career and technical education spaces
 - Early College Science, Technology, Engineering and Mathematics (STEM) classrooms
 - Science labs
- Demolition of the Anthony Wing
- Roof replacement
- Right of way improvements
- Electrical, mechanical and plumbing upgrades
- Accessibility improvements
- Exterior envelope, structural and basement repairs



Public Building Commission of Chicago

Contractor Networking Session

November 21, 2013

Phase I: Scope

Bid Package #1 – Renovation (~ 85,000SF Interior Program + MEP Upgrades + Site Development)

- All interior program scope included but not limited to: Navistar, Carpentry, Allied Health, Horticulture, CTE programs, Cosmetology, Culinary, Early College STEM (ECS) spaces & Science Labs
- MEP upgrades to service CTE programs
- Full Roof Replacement w/parapet and Cap termination including raised roof equipment: Knuckle, 87th and Chappel Wings
- Limited [ADA] American Disabilities Act Accessible Improvements
- Structural repairs at 87th Wing Gymnasium
- Exterior Façade Restoration repairs/renovation (Including structural repairs)
- [PROW] Right of Way Improvements: Curbs and Sidewalks, ADA curb ramps, Driveways, Parkways, Ornamental Fencing, and Landscaping
- [CDOT] Chicago Depart of Transportation improvements: Street Signage, Street Lighting, Traffic Signal Management
- Site Landscape & Civil scope
- Central Plant Mechanical, Electrical and Plumbing Systems Upgrades & for building programs (Incl. Abatement)
- Basement repairs (Plenum, access, ceilings, electrical, lighting etc.)
- Building Heating System Start
- MEP Commissioning [March 2015], Air Conditioning to CTE programs



Public Building Commission of Chicago

Contractor Networking Session

November 21, 2013

Phase II: Scope

Bid Package #2 – Abatement & Demolition (≈ 150,000 SF Building + Site Development + Greenhouse)

- Full Abatement Only of the two-story plus basement building of the Anthony Wing
- Demolition only of the two-story plus basement building of the Anthony Wing
- Façade enclosure work at link to knuckle
- Site Civil storm water management and service drive (After Anthony Wing building demolition)
CTE Greenhouse w/associated site work and Learning Garden
(After A-Wing building demolition)
- Landscaping and Site restoration (After Anthony Wing building demolition)



Public Building Commission of Chicago

Contractor Networking Session

November 21, 2013

LEGEND

- Allied Health
- Art
- Auditorium
- Building Support
- Carpentry
- Cosmetology
- Culinary
- ECS (STEM)
- General Classroom
- Horticulture
- Music
- Navistar
- OSes
- PE
- Science

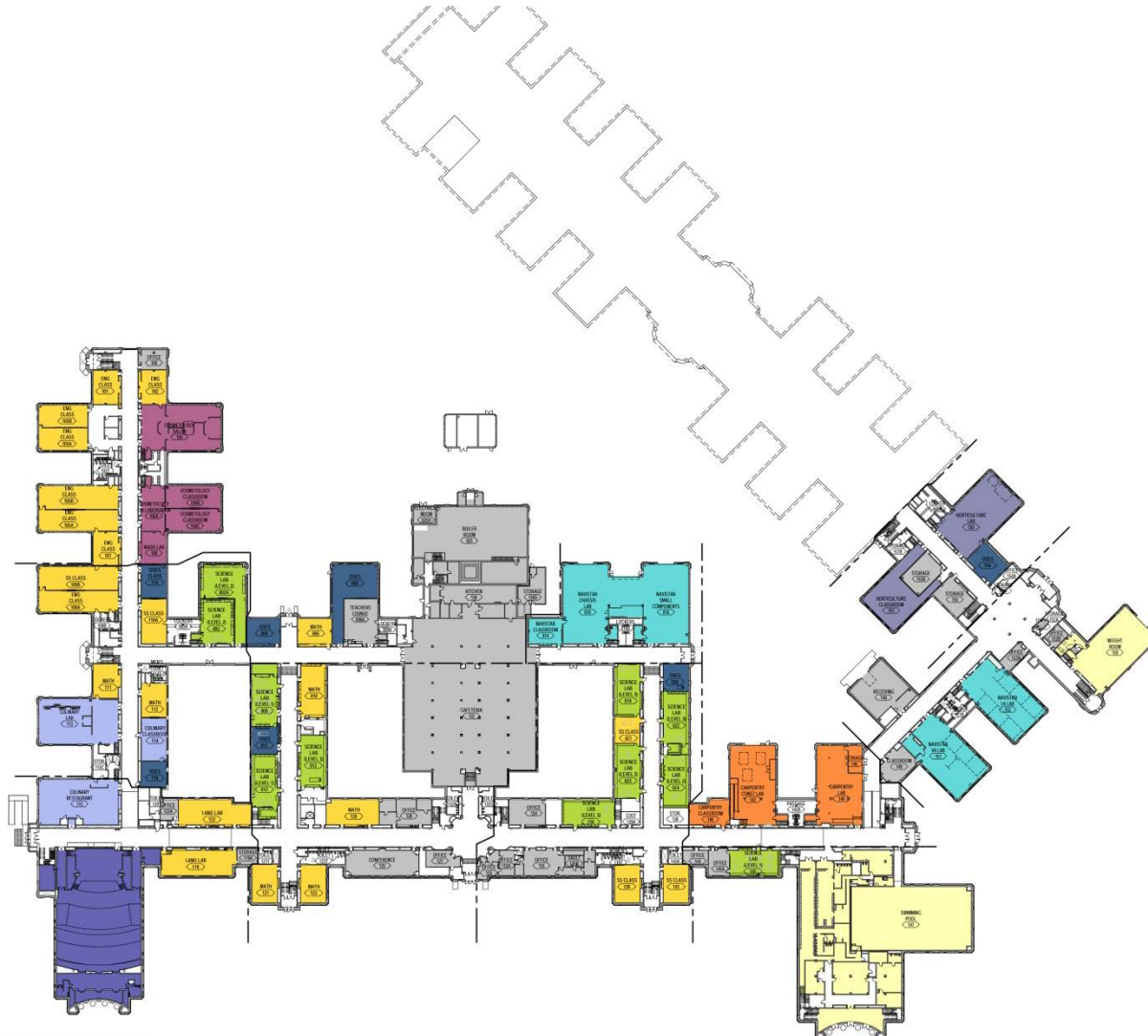

First Floor





Public Building Commission of Chicago

Contractor Networking Session

November 21, 2013

LEGEND

- Allied Health
- Art
- Auditorium
- Building Support
- Carpentry
- Cosmetology
- Culinary
- ECS (STEM)
- General Classroom
- Horticulture
- Music
- Navistar
- OSES
- PE
- Science

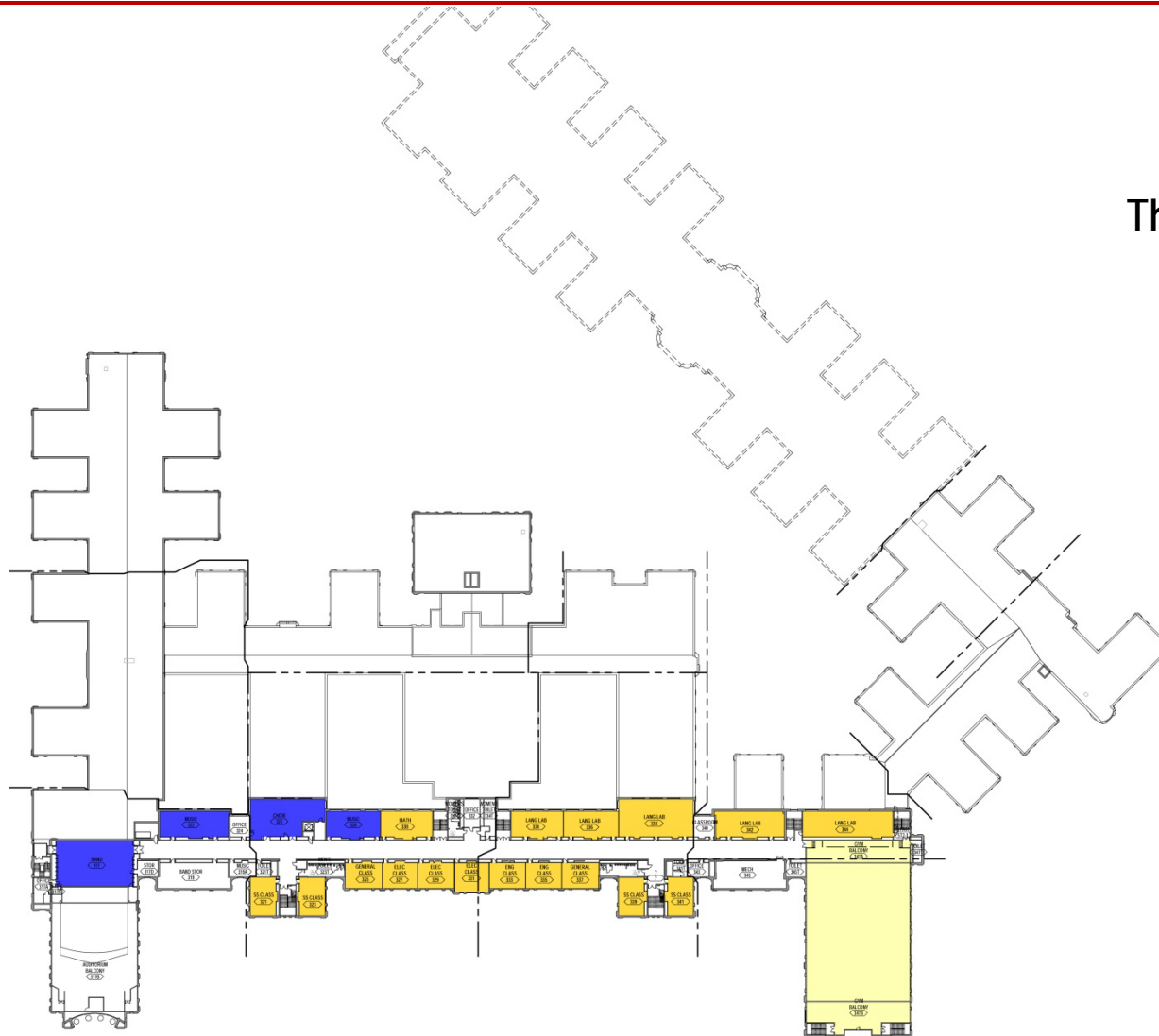

Third Floor



Public Building Commission of Chicago

Contractor Networking Session

November 21, 2013

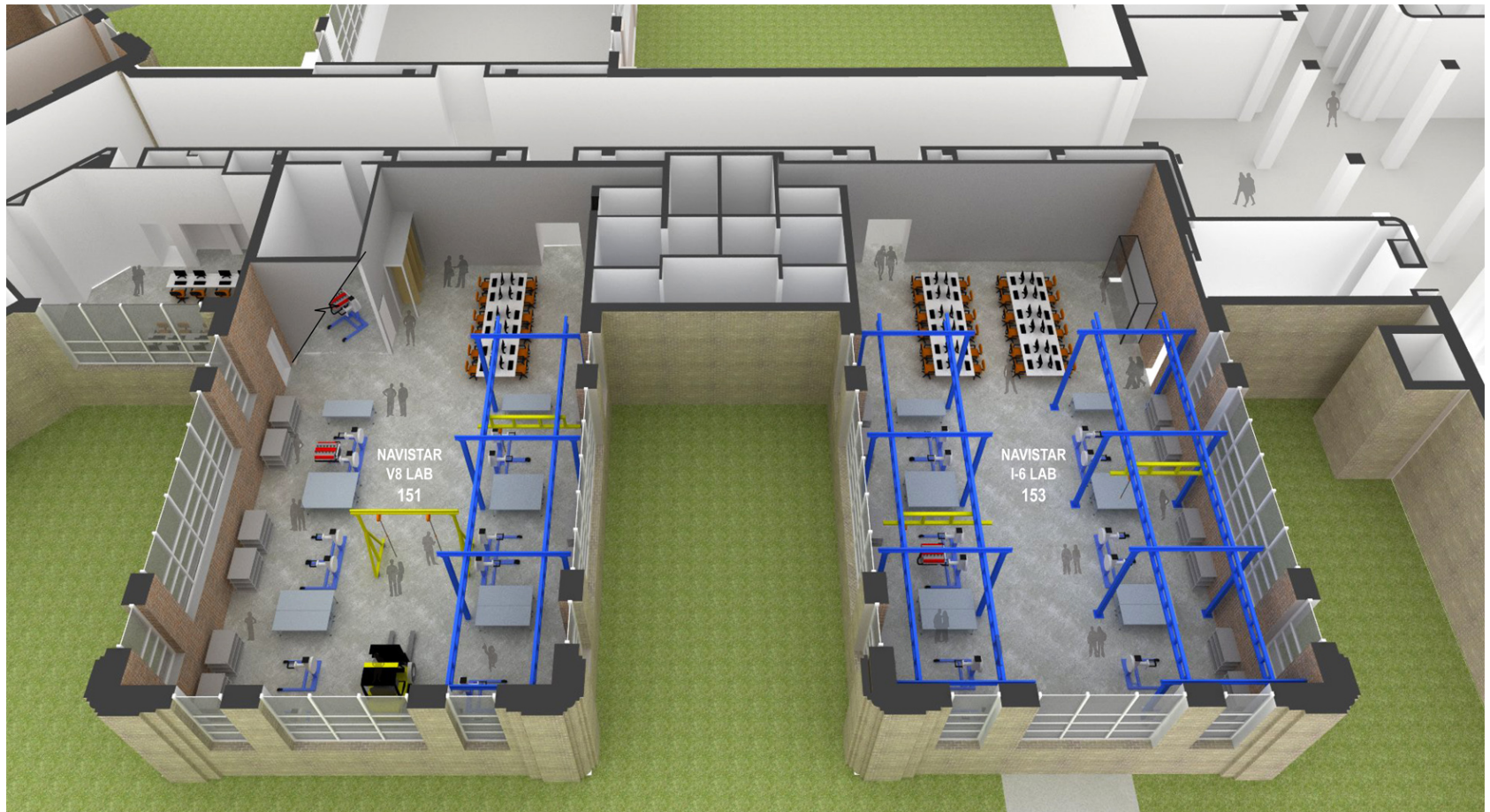



Public Building Commission of Chicago

Contractor Networking Session

November 21, 2013

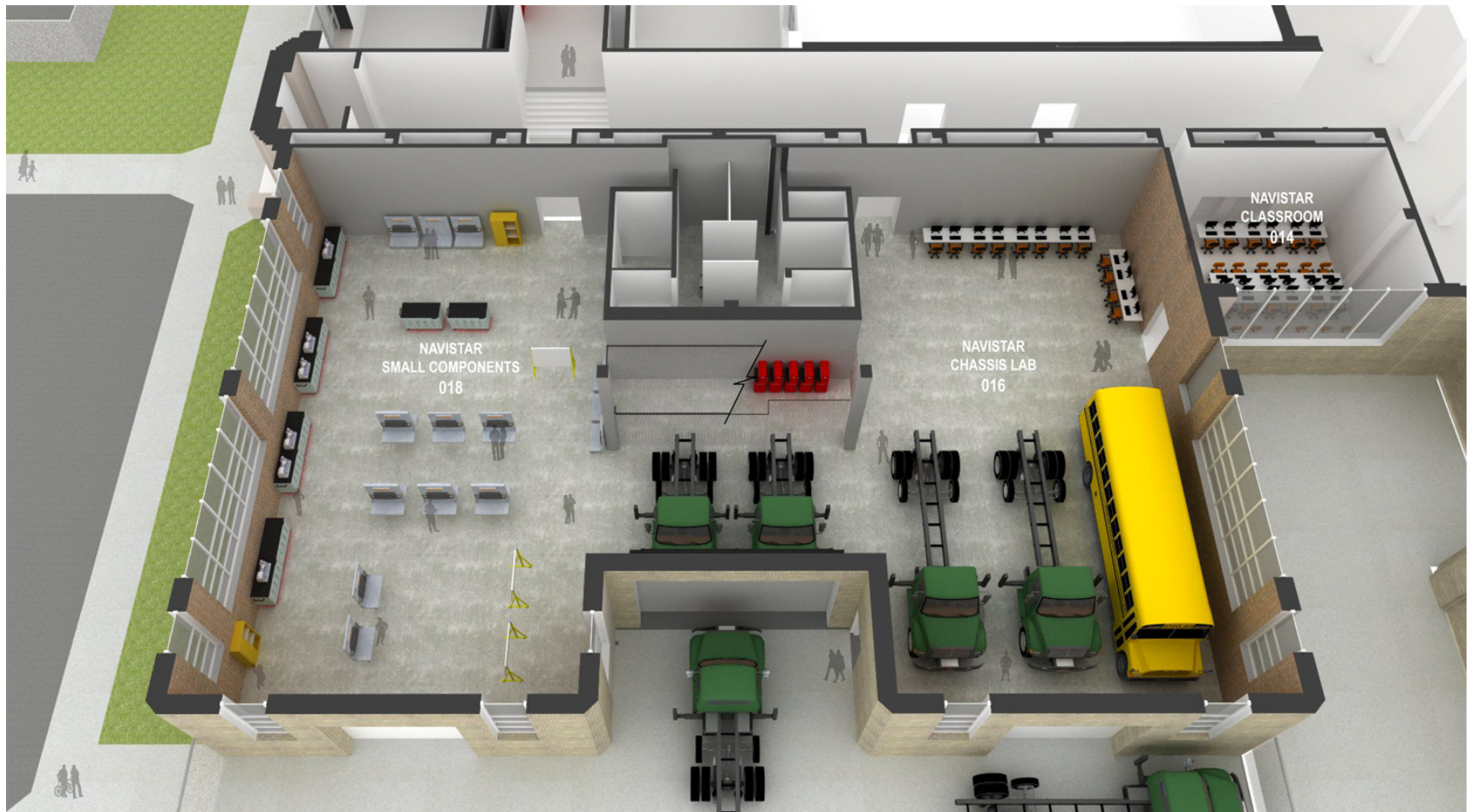



Public Building Commission of Chicago

Contractor Networking Session

November 21, 2013





Public Building Commission of Chicago

Contractor Networking Session

November 21, 2013





Public Building Commission of Chicago

Contractor Networking Session

November 21, 2013





Public Building Commission of Chicago

Contractor Networking Session

November 21, 2013





Public Building Commission of Chicago

Contractor Networking Session

November 21, 2013

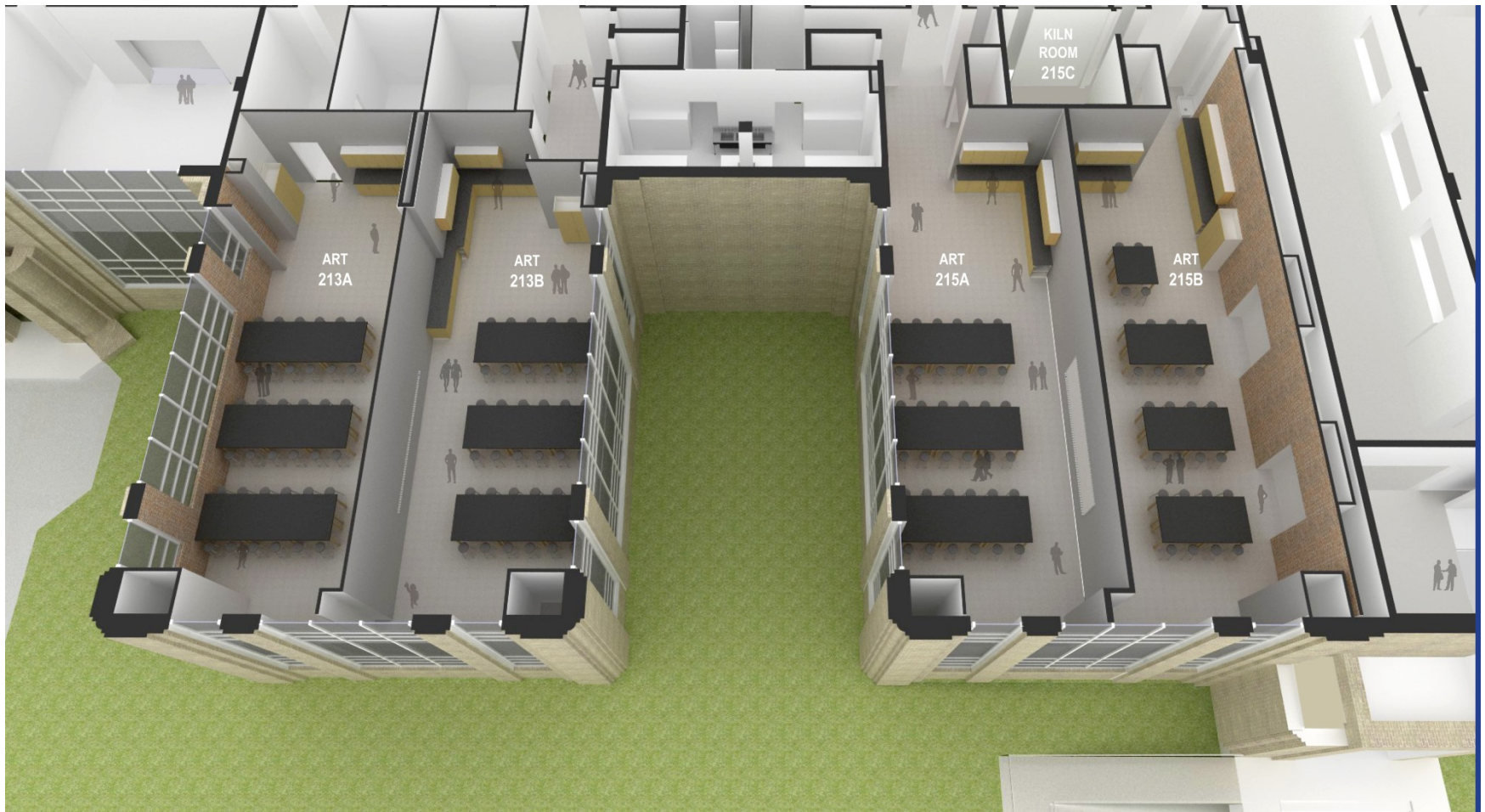



Public Building Commission of Chicago

Contractor Networking Session

November 21, 2013

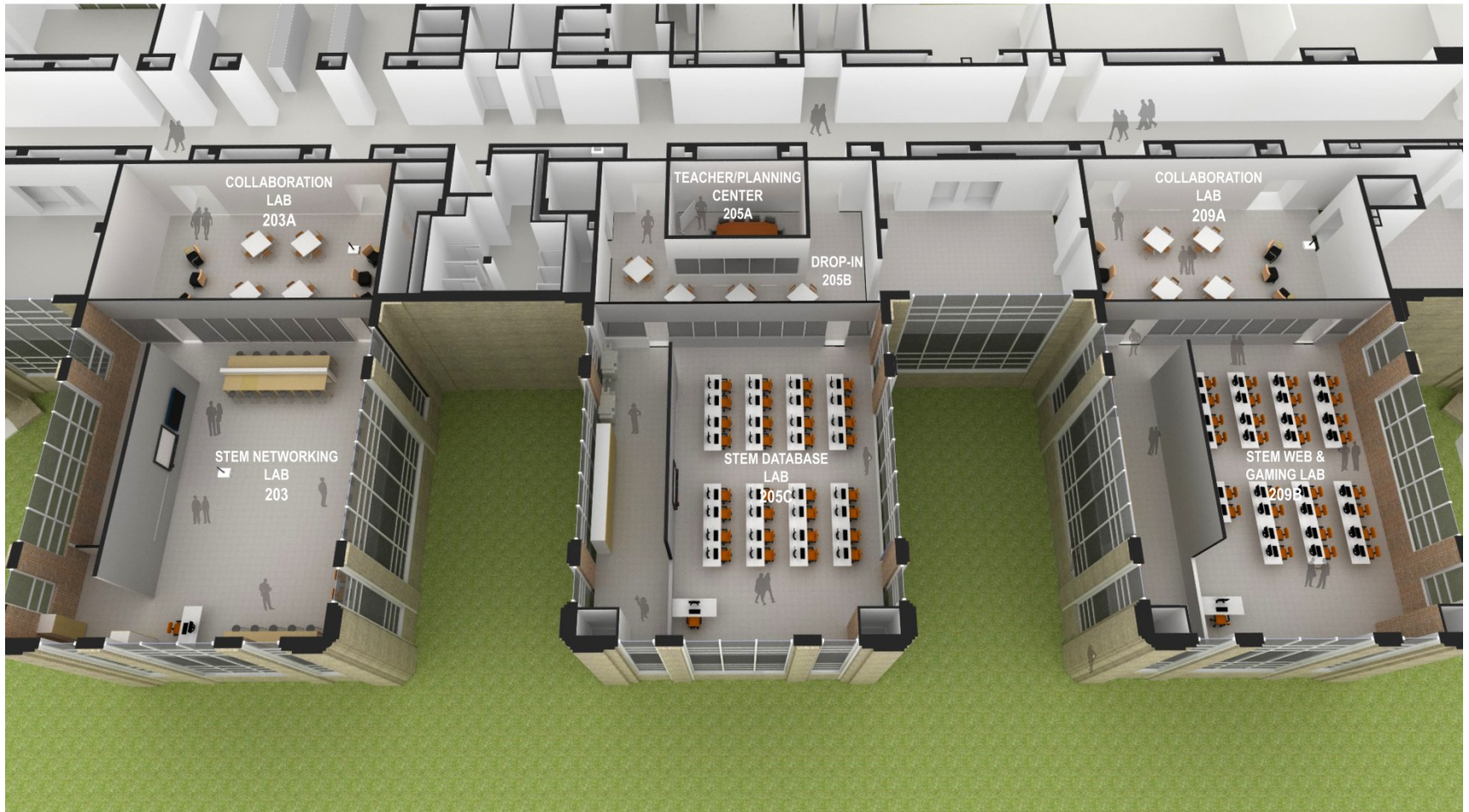



Public Building Commission of Chicago

Contractor Networking Session

November 21, 2013





Public Building Commission of Chicago

Contractor Networking Session

November 21, 2013

Phasing Plan



Public Building Commission of Chicago

Contractor Networking Session

November 21, 2013





Public Building Commission of Chicago

Contractor Networking Session

November 21, 2013

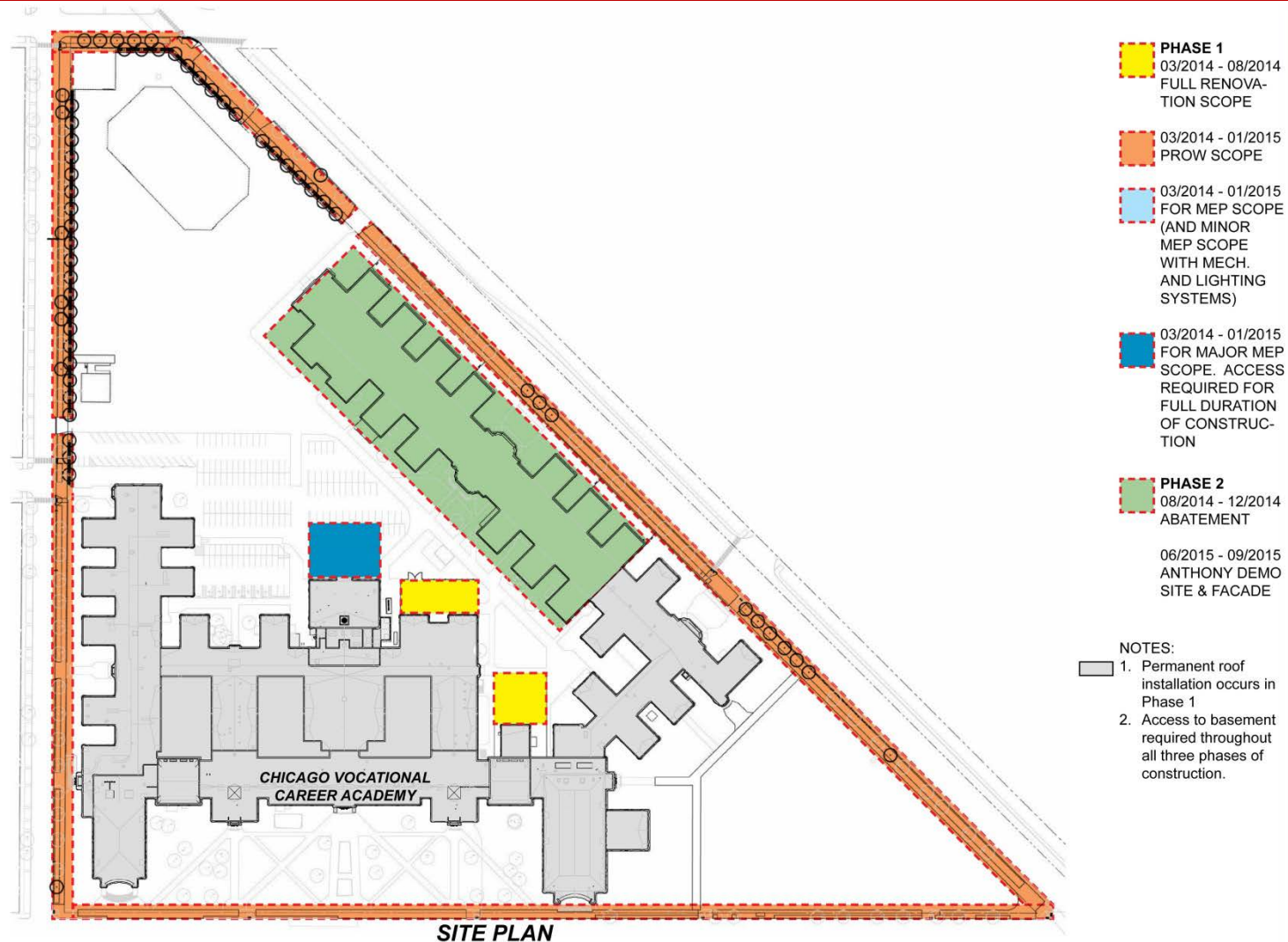



Public Building Commission of Chicago

Contractor Networking Session

November 21, 2013

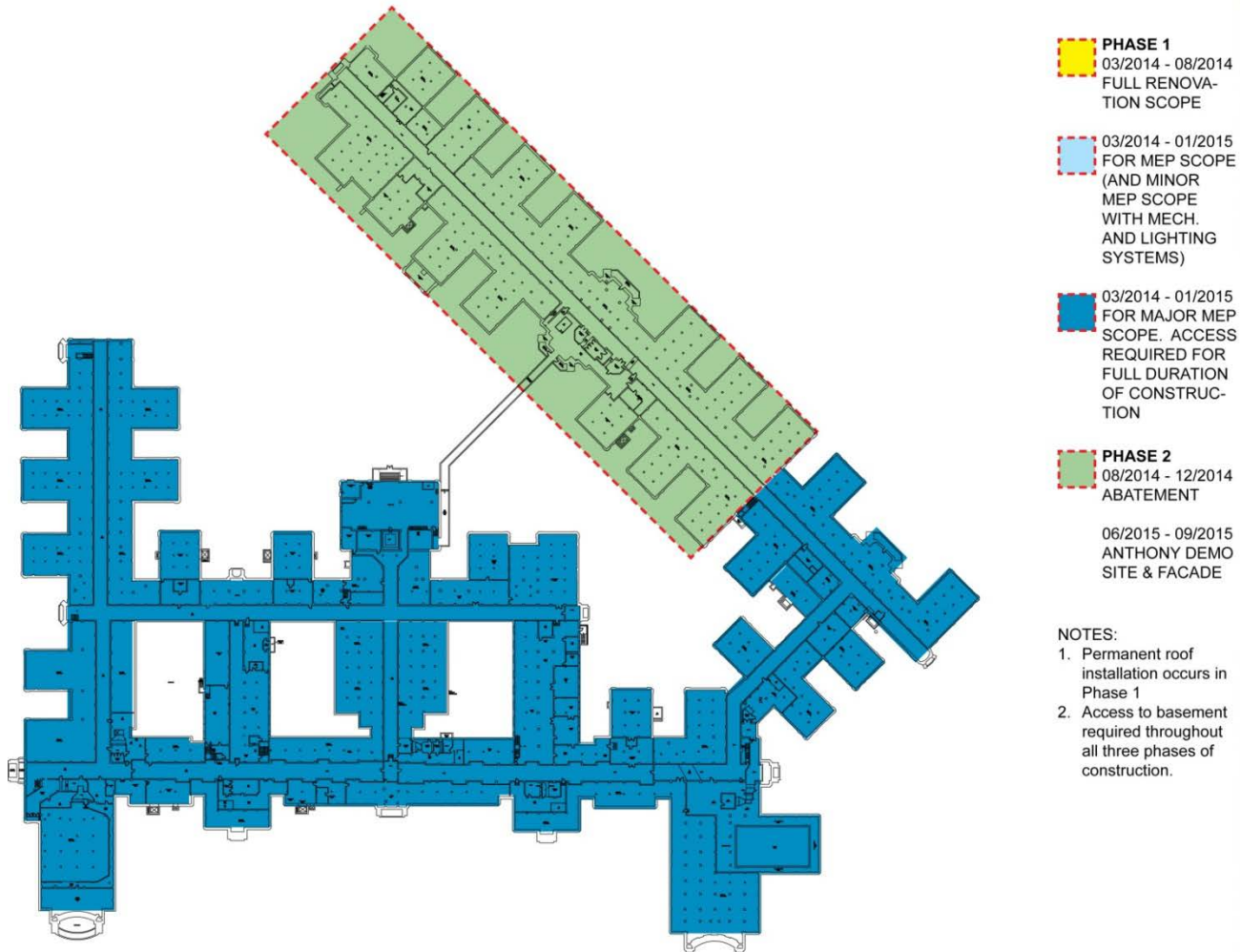

LOWER LEVEL FLOOR PLAN



Public Building Commission of Chicago

Contractor Networking Session

November 21, 2013



- NOTES:
1. Permanent roof installation occurs in Phase 1
 2. Access to basement required throughout all three phases of construction.



Public Building Commission of Chicago

Contractor Networking Session

November 21, 2013

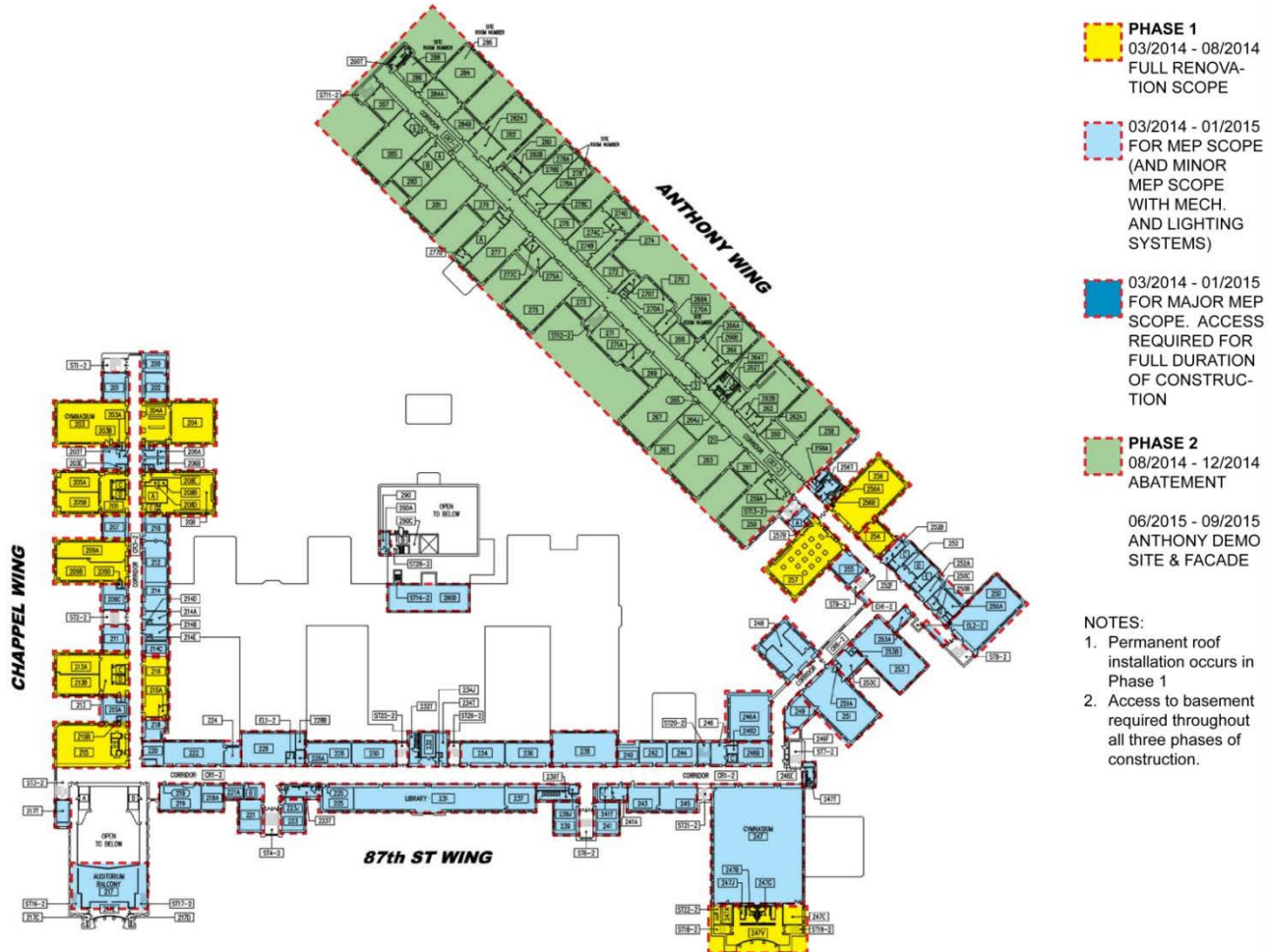

SECOND LEVEL FLOOR PLAN



Public Building Commission of Chicago

Contractor Networking Session

November 21, 2013

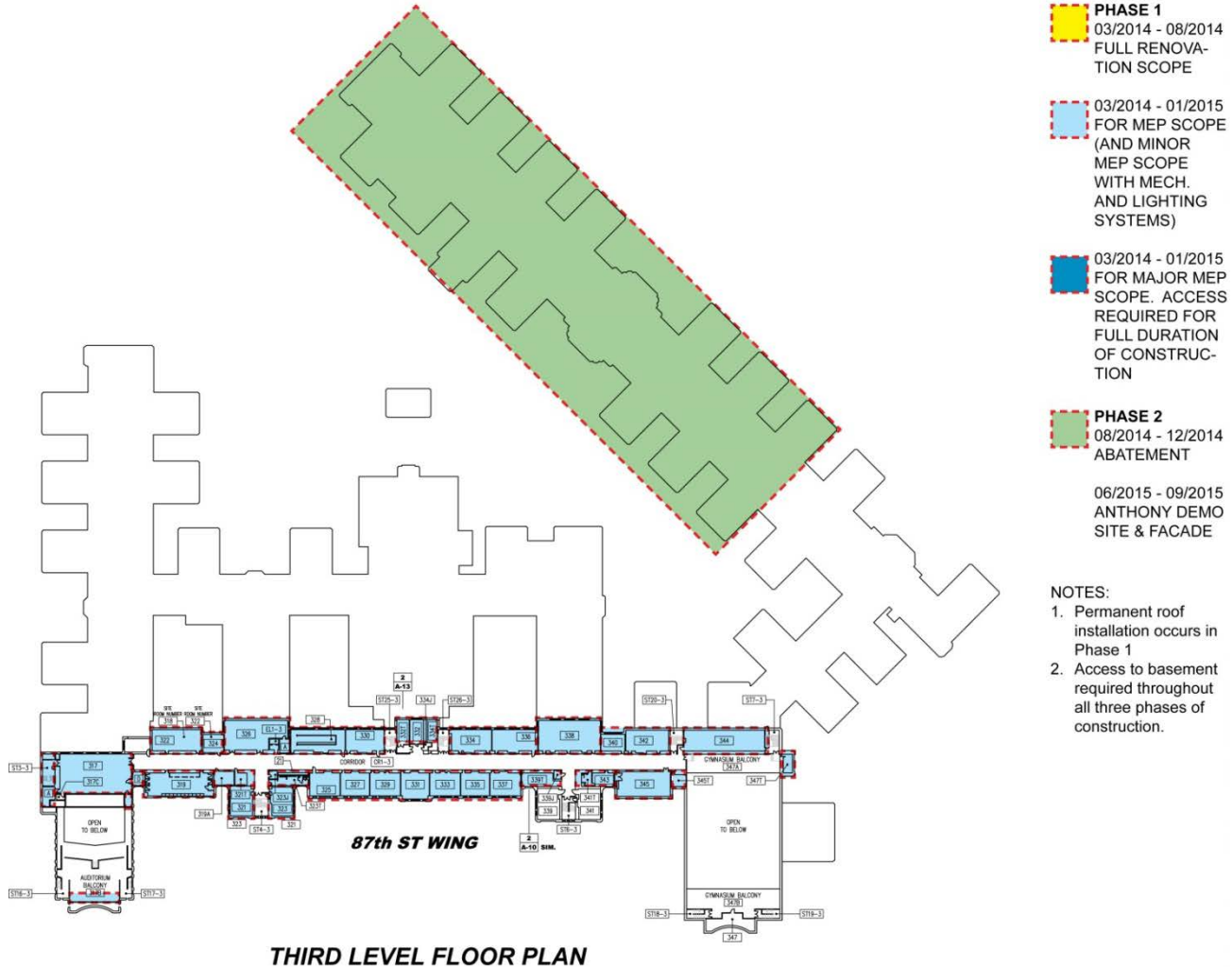



Public Building Commission of Chicago

Contractor Networking Session

November 21, 2013

Phase I: Schedule

- Bid on Jan 03, 2014; Estimated Construction from Feb 2014 to Jan 2015
 - Substantial completion milestone 1/Interior renovation program: August 2014
 - Substantial completion milestone 2/MEP and exterior: Mid December 2014

Phase II: Schedule

- Bid in Jul 2014, Estimated Construction from Aug 2014 to Sept 2015
 - Substantial completion of demolition work: August 2015



Public Building Commission of Chicago

Contractor Networking Session

November 21, 2013

PBC DIVERSITY PROGRAM

CHARLES KELLY,
*DEPUTY DIRECTOR
OF COMPLIANCE & DIVERSITY, PBC*



Public Building Commission of Chicago

Contractor Networking Session

November 21, 2013

Building Community: Program Objectives

- M/WBE
- Levels the playing field for all firms
- Support community hiring
- Support student hiring
- Economic sustainability
- Local business hiring
- Diversify the skilled trades
- Builds competition through capacity building



Public Building Commission of Chicago

Contractor Networking Session

November 21, 2013

Minority Business Enterprise (MBE) & Women Business Enterprise (WBE)



Public Building Commission of Chicago

Contractor Networking Session

November 21, 2013

M/WBE Certifications

- City of Chicago
- Cook County



Public Building Commission of Chicago

Contractor Networking Session

November 21, 2013

Minority Business Enterprise (MBE) and Women Business Enterprise (WBE) Goals:

- Minimum MBE - 24%
- Minimum WBE - 4%

Project Specific Goals

- MBE – 30%
- WBE – 5%



Public Building Commission of Chicago

Contractor Networking Session

November 21, 2013

Work Site Employment Requirements

- The PBC requires that General Contractors commit to a construction work site employment program that addresses the following employment goals:

WORKFORCE	PROJECT EMPLOYMENT GOAL
City of Chicago Residents	50% of construction work hours to be performed by City of Chicago Residents
Community Residents	7.5% of construction work hours to be performed by residents of the "Project Community" designated for each Project
Student Interns	



Public Building Commission of Chicago

Contractor Networking Session

November 21, 2013

Community Hiring Dates

- Tentative: Thursday, February 27, 2014 from 3:00-7:00 p.m.
- Tentative: Thursday, March 6, 2014 from 3:00-7:00 p.m.



Public Building Commission of Chicago

Contractor Networking Session

November 21, 2013

Work Site Employment Requirements

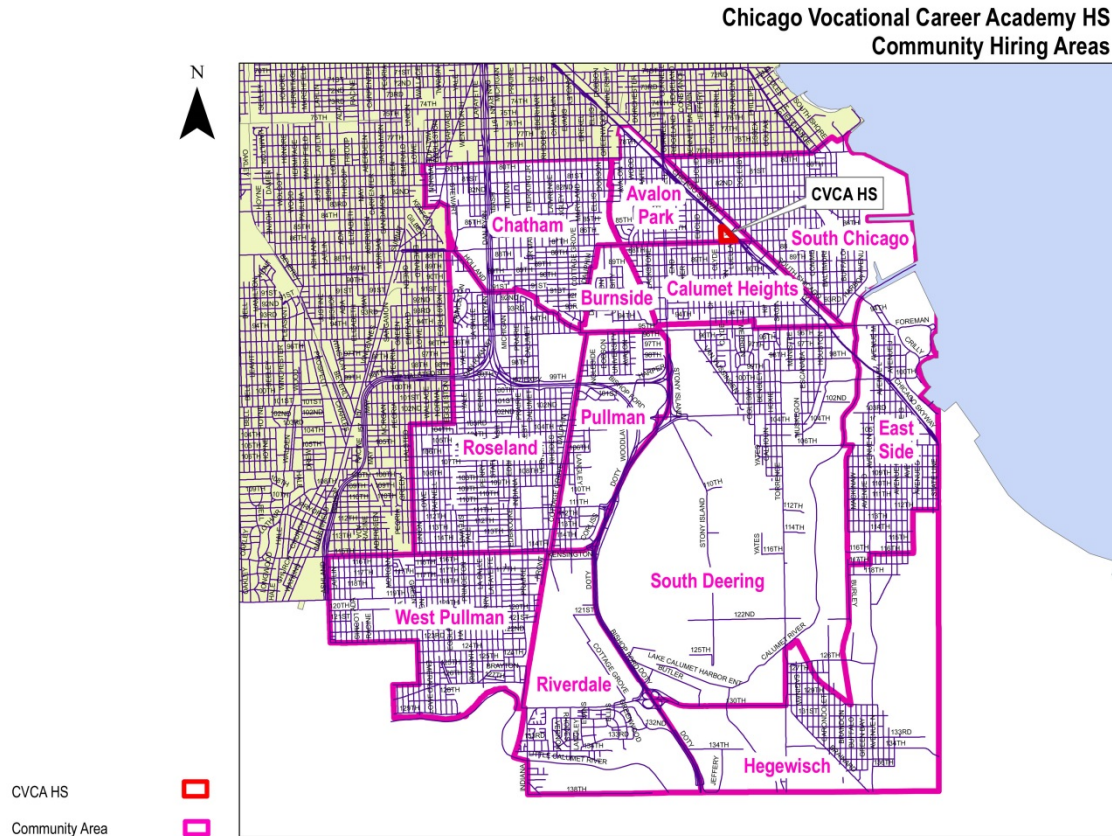



Public Building Commission of Chicago

Contractor Networking Session

November 21, 2013

Compliance

- EEO:
 - Electronic submission of weekly certified payrolls via LCP Tracker
 - Certificate of Apprenticeship from U.S. Department of Labor, Bureau of Apprenticeship and Training
- Reporting:
 - EEO reports generated via LCP Tracker
- Enforcement mechanisms
 - Assessment of Liquidated Damages for EEO and City residency non-compliance
 - Responsible Vendor: EEO and City residency liquidated damages assessments reviewed



Public Building Commission of Chicago

Contractor Networking Session

November 21, 2013

CONTRACTS

LORI LYPSON,
CHIEF OPERATING OFFICER, PBC



Public Building Commission of Chicago

Contractor Networking Session

November 21, 2013

Prequalified GC's for Phase I Renovation

- Berglund Construction Company
- Blinderman Construction Company
- Burling Builders, Inc.
- Friedler Construction Co.
- James McHugh Construction Co.
- Old Veteran Construction, Inc.
- Power & Sons Construction/IHS Construction JV
- The George Sollitt Construction Company
- Tyler Lane/Illinois Window & Glass JV
- Wight Construction Services



Public Building Commission of Chicago

Contractor Networking Session

November 21, 2013

Prequalified GC's for Phase II Demolition

- American Demolition Corporation
- Berglund Construction Company
- Brandenburg Industrial Service Company
- Friedler Construction Co.
- McDonagh Demolition Inc.
- Old Veteran Construction, Inc.
- Power & Sons Construction/IHS Construction JV



Public Building Commission of Chicago

Contractor Networking Session

November 21, 2013

Accessing Bid Opportunities

www.pbcchicago.com

- Access current solicitations
 - Upcoming Bid Opportunities
- Instant notifications
 - PBC Alert
- Newspaper Advertisements
 - Sun-Times
- Social Media
 - Facebook @ Public Building Commission of Chicago
 - Twitter @ pbcchi



Public Building Commission of Chicago

Contractor Networking Session

November 21, 2013

REMARKS

MICHELLE HARRIS,
ALDERMAN, 8TH WARD, CITY OF CHICAGO

DONNE E. TROTTER,
SENATOR, 17TH DISTRICT, ILLINOIS



Public Building Commission of Chicago

Contractor Networking Session

November 21, 2013

All Questions Regarding Upcoming Bid
Should be Addressed to:

•Rusty Castillo
Deputy Director of Procurement
rusty.castillo@cityofchicago.org